

Guard Against Fuel Theft

May 20, 2021 - Dover Fueling Solutions recognizes the importance of protecting customer assets and guarding against fuel theft. Implementing the important steps outlined below will prevent unauthorized fuel dispensing.

The standalone jumper should always be removed after installation or startup of dispensers. As a standard service practice when inside the electronic cabinet, always check to ensure the standalone jumper has been removed. If the jumper is installed, it should be removed prior to closing the bezel door. Do not leave the jumper inside the dispenser. The standalone setting is located on different printed circuit boards depending on dispenser type. Refer to the appropriate installation manual for location of the jumper.

- [Anthem Ovation Installation Operation \(P/N WU019276\)](#)
- [Ovation2 Service Manual \(P/N WU010466\)](#)
- [WM048523 Helix Service Manual Rev 10](#)
- [WU021846, Rev 01 Select Install Manual Gen 2 Ph 2 Jan 2021](#)

During startup of any dispenser, the Service Engineer password and Station Manager password (Function 33) should be changed from default to a unique password in accordance with customer requirements. In addition, you may also restrict access to the filling mode under function 21.01.

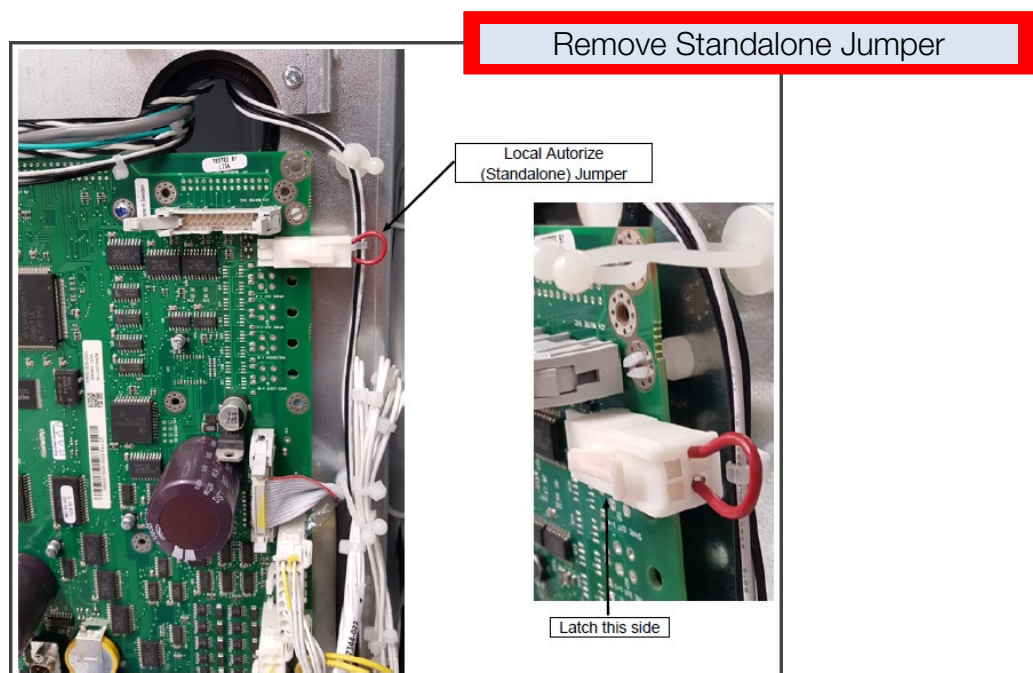

For questions, please contact your DFS Regional Service Manager.